

Multipack 4-colours 502XL Ink



Providing a low-cost yet reliable printing solution, this affordable four-colour ink benefits from Epson's extensive research and development. Producing clear and vibrant prints, the 502 ink is optimised to work with Epson's range of printers. It can produce an array of documents with defined text and graphics.

Low cost yet reliable

Enjoy reliable, vibrant and clear prints with minimal outlay using Epson's four-colour 502 ink. Thanks to the combination of dye colours and pigment black inks, this inkset produces defined and colourful prints.

Reduce your printing costs with XL inks

Epson offers a choice of standard or extra large (XL) ink cartridges across its latest ink ranges. XL inks are ideal if you print high volumes and can help to reduce your printing costs.

Optimised for Epson printers

Epson inks and papers have been developed to work hand-in-hand with Epson printers to produce the best results time and time again.

The genuine article

Enjoy hassle-free and reliable printing with Epson's genuine inks. We invest in extensive research, high-tech manufacturing facilities and put our products through rigorous tests, to deliver the best quality product to you.

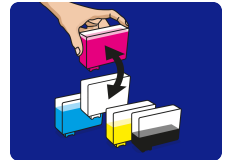

PRODUCT SPECIFICATIONS

PACKAGING	
Package Type	Multipack

TECHNOLOGY	
Content	1 x 9,2 ml Black, 1 x 6,4 ml Cyan, 1 x 6,4 ml Magenta, 1 x 6,4 ml Yellow
Short Name	502XL
Symbol	Binoculars
Size	XL

Multipack 4-colours 502XL Ink

LOGISTICS INFORMATION

SKU	C13T02W64010
EAN code	8715946653198
Carton Weight	0 Kg
Multiple Order Quantity	8 Units
Country of Origin	Indonesia

Epson Deutschland GmbH
Otto-Hahn-Str. 4
D-40670 Meerbusch
Info-Line: 02159 92 79 500
Telefax: +49 (0) 2159/538-3000
www.epson.de

Epson in Österreich
Info-Line: 01 253 49 78 333
www.epson.at
Epson in der Schweiz
Info-Line: 022 592 7923
www.epson.ch

Alle Marken und eingetragenen Warenzeichen sind das Eigentum der Seiko Epson Corporation oder der jeweiligen Rechteinhaber.
Diese Produktinformationen können ohne vorherige Ankündigung geändert werden.

EPSON[®]