

Jabra®

# JABRA SPEAK 810

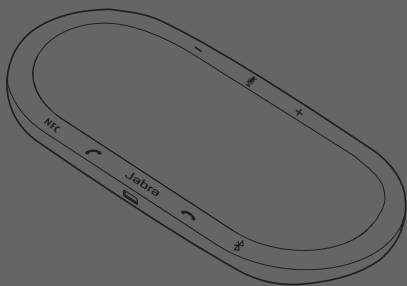

User Manual

[jabra.com/speak810](http://jabra.com/speak810)

A BRAND BY

**GN Netcom**

---

© 2015 GN Netcom A/S. All rights reserved. Jabra® is a registered trademark of GN Netcom A/S. All other trademarks included herein are the property of their respective owners. The Bluetooth® word mark and logos are owned by the Bluetooth SIG, Inc. and any use of such marks by GN Netcom A/S is under license. (Design and specifications subject to change without notice).

---

MADE IN CHINA  
MODEL:PHS004W



---

**Declaration of Conformity** can be found on  
[www.jabra.com/CP/US/declarations-of-conformity](http://www.jabra.com/CP/US/declarations-of-conformity)

# CONTENTS

1. WELCOME .....	4
2. SPEAKER OVERVIEW .....	5
3. HOW TO POSITION.....	6
4. CONNECT TO POWER .....	7
4.1 CHARGING YOUR PHONE OR TABLET	
5. HOW TO CONNECT .....	8
5.1 CONNECT TO USB DEVICE	
5.2 CONNECT TO HEADSET PORT ON MOBILE DEVICE	
5.3 CONNECT TO BLUETOOTH DEVICE	
5.4 CONNECT TO NFC-ENABLED DEVICE	
5.5 CONNECT TO JABRA LINK 360	
6. HOW TO USE .....	13
7. SOFTWARE .....	14
7.1 JABRA DIRECT	
7.2 UPDATE JABRA SPEAK 810 FIRMWARE	
8. SUPPORT .....	15
8.1 FAQ	
8.2 HOW TO CARE FOR YOUR HEADSET	
9. TECHNICAL SPECIFICATIONS .....	16

# 1. WELCOME

Thank you for using the Jabra Speak 810. We hope you will enjoy it!

## **JABRA SPEAK 810 FEATURES**

- Zoom Talk microphone with adaptive directionality 5 m/15 ft. range (15 persons)
- Connectivity: USB, BT/NFC & 3.5 jack
- Built-in tablet & mobile phone charging port
- Option to attach a Kensington lock

## 2. SPEAKER OVERVIEW

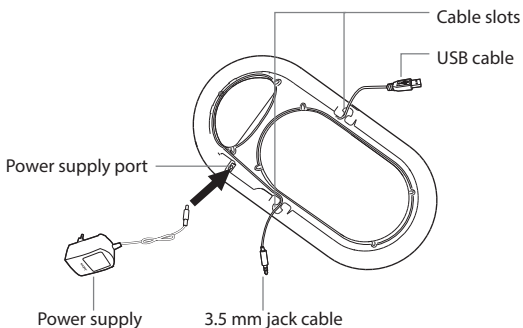
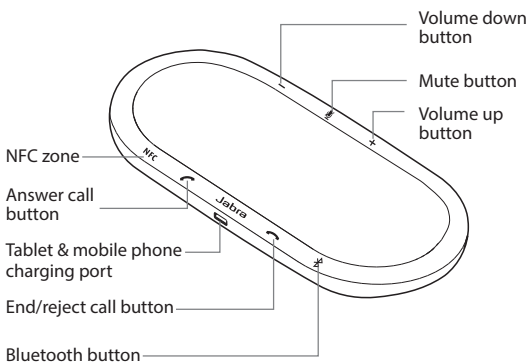

### 3. HOW TO POSITION

For the best audio quality:

- Place the Jabra Speak 810 onto a flat surface, ideally in the center of the meeting group.
- Do not cover the speaker with stickers or labels.
- Do not balance the Jabra Speak 810 on top of cables. Use the cable slots on the base.
- Ensure to adjust the speaker volume to best suit your needs.

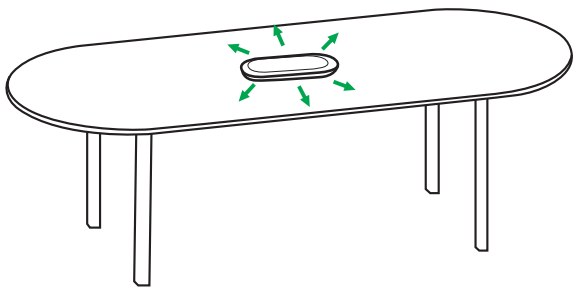

## 4. CONNECT TO POWER

Plug the power supply into the power supply port on the base of the Jabra Speak 810, secure the cable in the cable slot, and then connect to power.

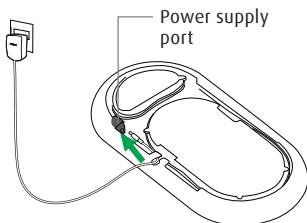

### 4.1 CHARGING YOUR PHONE OR TABLET

---

You can charge your mobile phone or tablet by using the Mobile charging port on the Jabra Speak 810.

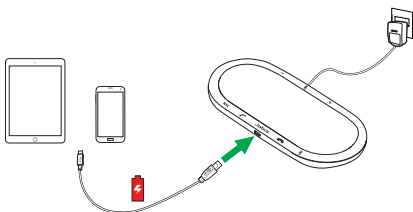

# 5. HOW TO CONNECT

## 5.1 CONNECT TO USB DEVICE

---

1. Ensure the Jabra Speak 810 is connected to power using the power supply.
2. Plug the attached USB cable into any USB port on your PC.

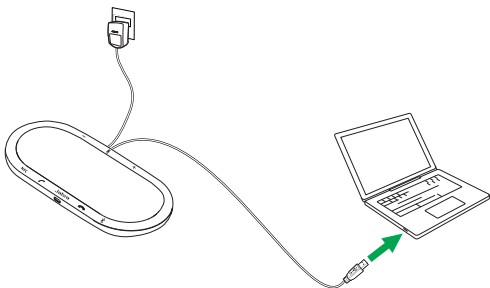



## 5.2 CONNECT TO HEADSET PORT ON MOBILE DEVICE

---

1. Ensure the Jabra Speak 810 is connected to power using the power supply.
2. Plug the attached 3.5 mm jack cable into the headset port on your mobile device.

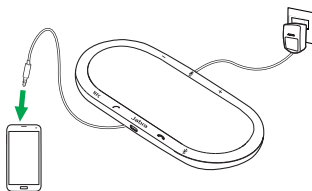

## 5.3 CONNECT TO BLUETOOTH DEVICE

---

1. Ensure the Jabra Speak 810 is connected to power using the power supply.
2. Tap the Bluetooth button on the Jabra Speak 810, and follow the voice-guided connection instructions.
3. Select the Jabra Speak 810 from the list of devices on your mobile device Bluetooth list.

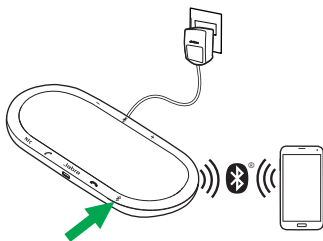

**NOTE:** To disconnect your Bluetooth device from the Jabra Speak 810, tap the **Bluetooth** button on the Jabra Speak 810.

## 5.4 CONNECT TO NFC-ENABLED DEVICE

---

1. Ensure the Jabra Speak 810 is connected to power using the power supply.
2. Slide your NFC-enabled device directly against the NFC zone on the Jabra Speak 810 until a connection is confirmed on your mobile device.

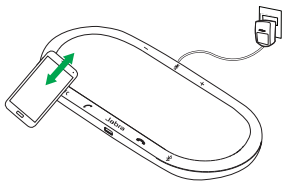

**NOTE:** To disconnect your NFC-enabled device from the Jabra Speak 810, slide it directly against the NFC zone on the Jabra Speak 810.

## 5.5 CONNECT TO JABRA LINK 360

---



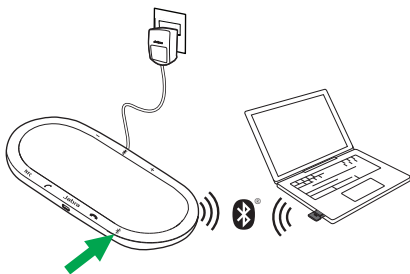

1. Ensure the Jabra Speak 810 is connected to power using the power supply.
2. Insert the Jabra Link 360 into your PC, and wait for it to automatically install the relevant drivers.
3. When the Jabra Link 360 starts flashing blue, tap the Bluetooth button on the Jabra Speak 810 to connect to the Jabra Link 360.
4. You will hear a connection confirmation when the Jabra Link 360 and the Jabra Speak 810 are connected.

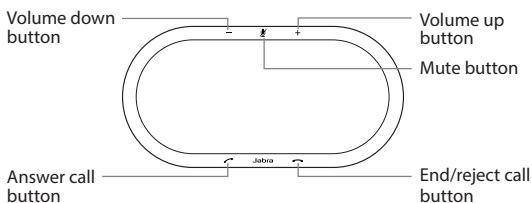

**NOTE:** To disconnect the Jabra Link 360 from the Jabra Speak 810, tap the **Bluetooth** button on the Jabra Speak 810.

## 6. HOW TO USE



	FUNCTION	ACTION
	Answer call	Tap the <b>Answer call</b> button
	End/reject call	Tap the <b>End/reject</b> button
	Volume up/ down	Tap, or press and hold, the <b>Volume +</b> or <b>Volume -</b> button
	Mute/unmute microphone	Tap the <b>Mute</b> button
	Enable/disable voice guidance	Press and hold (8 secs) the <b>Mute</b> button

# 7. SOFTWARE

## 7.1 JABRA DIRECT

---

Jabra Direct is software designed to support, manage and enable optimal functionality for Jabra devices. It is highly recommended to download and install Jabra Direct on your PC.

Download the latest version from [jabra.com/direct](https://jabra.com/direct)

## 7.2 UPDATE JABRA SPEAK 810 FIRMWARE

---

Firmware updates improve performance or add new functionality to Jabra devices.

### **TO UPDATE FIRMWARE:**

1. Connect the Jabra Speak 810 to a PC using the attached USB cable.
2. Download and install Jabra Direct on your PC.
3. Check for the latest firmware via Jabra Direct. You will receive update notifications whenever there is an update available for your device.

# 8. SUPPORT

## 8.1 FAQ

---

View the Jabra Speak 810 FAQ on [jabra.com/speak810](http://jabra.com/speak810)

## 8.2 HOW TO CARE FOR YOUR JABRA SPEAK 810

---

- Avoid storage at extreme temperatures (above 45°C/113°F or below -5°C/23°F)
- Do not expose the Jabra Speak 810 to rain or other liquids
- Do not cover the Jabra Speak 810 with stickers or labels

## 9. TECHNICAL SPECIFICATIONS

JABRA SPEAK 810	SPECIFICATION
Weight:	965 g
Dimensions:	L 360 mm x W 180 mm x H 39.5 mm
Microphones:	6 digital microphones
Speaker:	2" high performance full range
Bluetooth range:	30 m
Bluetooth version:	4.1
Paired devices:	1 active connection. Up to 900 paired connections stored in the Jabra Speak 810
Supported Bluetooth profiles:	A2DP(v1.2), Hands Free Profile (v1.6), Headset profile(v1.2)
Tablet and mobile phone charging port support:	2.1A
Standby consumption:	0.15W
Max consumption:	25W



JABRA SPEAK 810	SPECIFICATION
Operating temperature:	5°C to 45°C (41°F to 113°F)
Storage temperature:	-5° C to 45°C (23°F to 113°F)
Pairing passkey or PIN:	0000

