

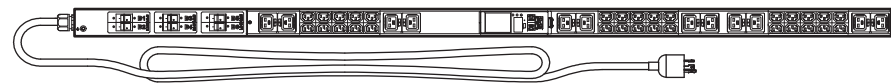

Installation and Quick Start Guide

NetShelter® Advanced 11000 Series Rack Power Distribution Units



Customer support and warranty information is available at www.se.com

© 2024–2025 Schneider Electric. APC and the APC logo are trademarks of Schneider Electric SE or its subsidiaries. All other brands may be trademarks of their respective owners.

EN TME44816A 01/2025

Important Information

The NetShelter® Rack Power Distribution Unit (PDU) Advanced is suitable for installation in Information Technology Rooms in accordance with Article 645 of the National Electric Code and NFPA 75.

For more information about APC products, go to www.se.com.

See the *NetShelter Advanced 11000 Series Rack Power Distribution Units User Guide* for detailed information on installation and operation. Enter your Rack PDU model number in the search bar at www.se.com, then select your rack PDU to view the product page, including all related documentation.

Warranty information is available at www.se.com.

You can register your product online at www.se.com.

NOTE: For important safety information, see the Safety Sheet included with your NetShelter Rack PDU Advanced.

NOTICE

- Be sure the Rack PDU is mounted securely and evenly.
- The ambient operating temperature of a closed or multi-unit rack environment may be greater than the ambient temperature of the room. Be sure the ambient operating temperature of your rack environment does not exceed the rated ambient operating temperature for the Rack PDU.

Additional Documentation

You can find the user guide and other documentation for this product at go2se.com/ref=<APDU11...>, where *APDU11...* is the model number of your NetShelter Rack PDU Advanced.

At the web page, select **Documentation > Product Documentation**.

You can also find documentation by scanning the QR code. All APDU11... models share a documentation set.



Receiving and Unpacking

Inspect the equipment



Carefully inspect the exterior of the shipment immediately upon receipt. If you detect shipping damage, contact your shipping company and APC Customer Support at www.se.com.



The shipping materials are recyclable. Save them for later use, or dispose of them appropriately.

Storage

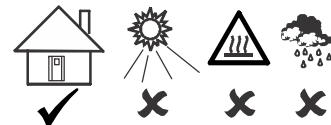

NOTICE

Leaving the equipment uncovered and exposed to the elements will cause damage and void the factory warranty.

Installation

The NetShelter Rack PDU Advanced can be installed to the vertical accessory channel of a NetShelter rack using the mounting pegs. The pegs will work in most rack enclosure designs.

The mounting pegs consist of a screw and washer. You can use a Phillips head screwdriver to change the location of the mounting pegs.

There are multiple mounting points for attaching the pegs on the back and on the side. Choose the mounting location for the pegs according to your needs.

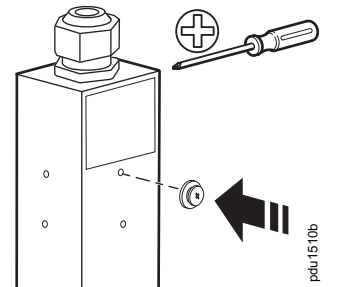

NOTE: The installation's receptacle/socket-outlet must have a Protective Earthing Connection. The plug on the power supply cord connects the Rack PDU's Protective Earthing Conductor to the installation's Protective Earthing Conductor.

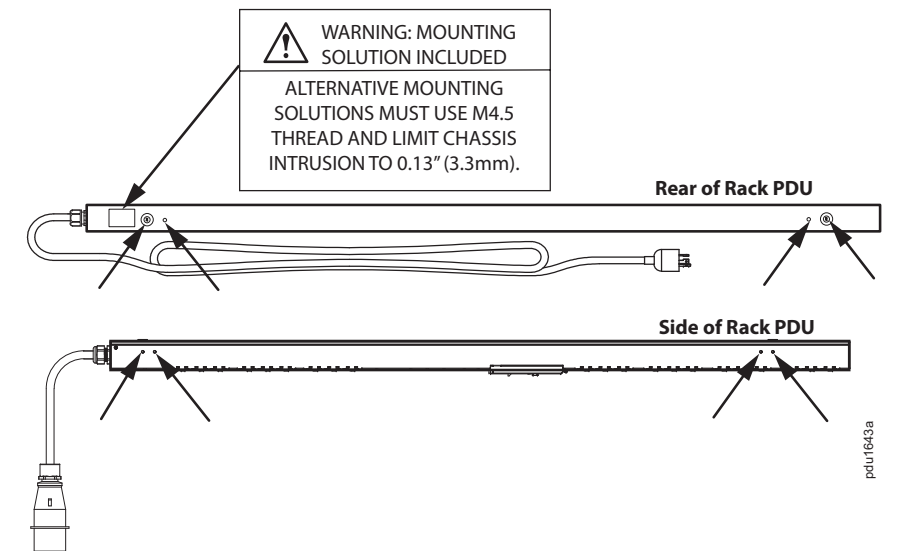

Two Rack PDUs can be installed on one vertical accessory channel in a NetShelter rack.

NOTE: The distance between mounting pegs varies depending on the Rack PDU model. The distance between mounting pegs for a full length Rack PDU is 1,555 mm (61.2 in). The distance for mid-length Rack PDUs is 1,244 mm (49.0 in), and the distance for half-length Rack PDUs is 622 mm (24.5 in).

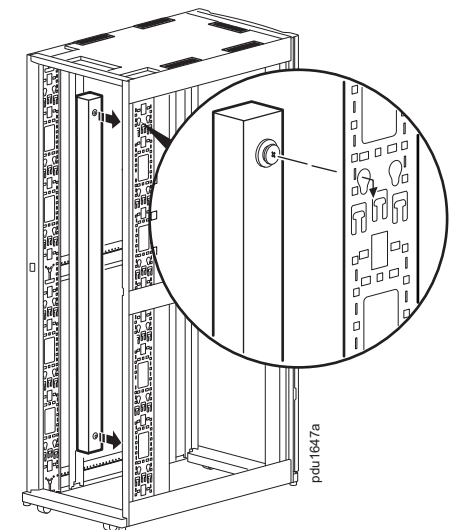

Power Cable

Route the power cable out of the rack and connect it to an appropriately rated branch circuit of your power source. The Rack PDU should be connected to a dedicated branch circuit protected by an appropriately sized circuit breaker. Turn the power feed circuit breaker ON, only after the connection to the Rack PDU is complete.

When startup is complete, the Main Menu will appear on the display screen.

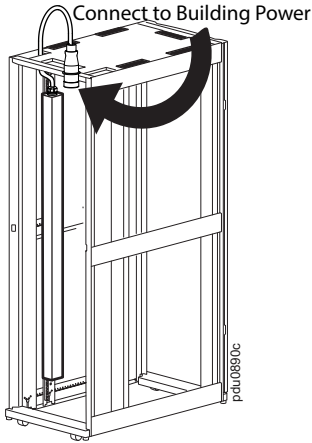

Quick Start Instructions

NOTE: See the *NetShelter Advanced 11000 Series Rack Power Distribution Units User Guide* available online at www.se.com for detailed instructions on configuring your settings.

NOTE: For security reasons, the username and password must be changed immediately after the first login.

The Display

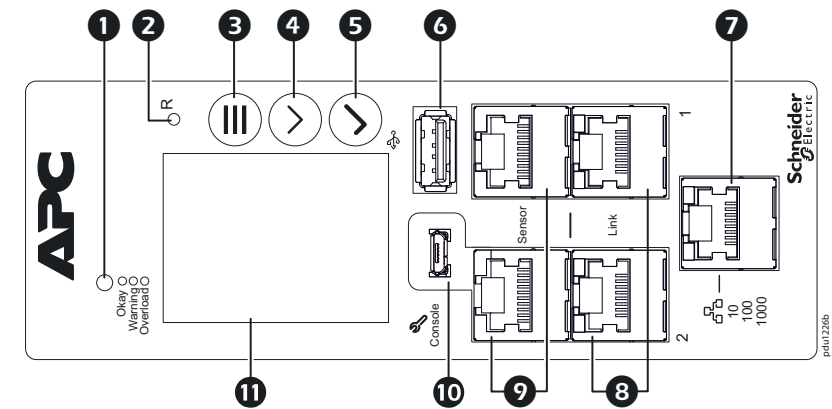

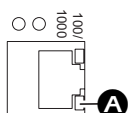
Item	Description	Function
1	Load Indicator LED	Indicates the status of the Rack PDU load and alarm levels.
2	Reset button	Resets the network management interface without affecting the outlets of the Rack PDU. To reset the network management interface without changing the configurations or the status of the outlets, press and release the button. To erase all configurations and restore the factory default settings, press and hold the button for 30 seconds, or until the Network Status LED blinks orange. 
3	Main Menu button	Press to return to the load status summary page.
4	Scroll button	Press once to display the menu. Press additional times to move the highlight bar down the menu list until you reach the desired item.
5	Select button	With a menu item highlighted, press the Select button to open the relevant status page.
6	USB port 5V @ 500 mA	For use with a flash drive to download log files, or to supply up to 100 mA at 5V to hardware accessories.
7	10/100/1000 Base-T Connector (Network port)	Connects the Rack PDU to the network using a Cat5e+ network cable.
8	Link 1 and Link 2 ports	For use with the Network Port Sharing (NPS) feature to connect multiple Rack PDUs to form an NPS group. This allows remote access to all devices within the group, provided at least one Rack PDU is connected to the network.

Item	Description	Function
9	Sensor ports	Port for connecting optional environment monitoring accessories: AP9335T, AP9335TH, NBES0301, NBES0302, NBES0303, NBES0304, NBES0305, or NBES0308. For more information about these accessories, see www.se.com .
10	Console port	Connects the Rack PDU to a local computer using a micro-USB cable (APC part number 960–0603), to configure initial network settings or access the command line interface (CLI).
11	Display panel	Shows information about the Rack PDU. In an idle situation, the displayed information will refresh every five seconds. The screen will automatically turn off after three minutes of inactivity. To reverse the text, select Display settings, scroll to LCD Orientation and press Select.

Connecting to the Network

By default, the NetShelter Rack PDU Advanced uses DHCP to assign network settings, resulting in a dynamic IP address. If you need a static IP address, you can enter the TCP/IP settings manually at the Command Line Interface (CLI). Once network settings are assigned, you can access the Web User Interface (Web UI).

DHCP Connection (Dynamic IP Address)

1. Connect a network cable to the Network port. The network connection is established when the Network Status LED turns solid green.
2. Press the Scroll button to display the menu.
3. Press the Scroll button until **Network** is selected. Press the Select button to view the IPv4 address of the Web UI. (You can press the Scroll button again to display the IPv6 address of the Web UI.)
4. Take note of the IP address for access to the Web UI.

Manual Connection (Static IP Address)

1. Contact your network administrator to obtain the IP address, subnet mask, and default gateway for the Rack PDU.
2. Connect an Ethernet cable to the Network port on the Rack PDU.
3. Open an application to view the COM ports for the computer, according to the instructions for your operating system. (In Windows operating systems, you can view ports in the Device Manager.)
4. Connect a USB-A to USB Micro-B cable (not provided) to the console port on the Rack PDU and to your computer. A newly occupied serial COM port should appear in the port-viewing application. Take note of the port number or re-assign the port as needed.
5. Use a terminal program (for example, Tera Term®) to make a serial connection to the NetShelter Rack PDU Advanced. Configure the selected port for 9600 bps, 8 data bits, no parity, 1 stop bit, and no flow control.
6. The CLI opens. Press Enter, repeatedly if necessary, to display the user name prompt.
7. Log on to the CLI of the NetShelter Rack PDU Advanced. The default user name and password are both **apc**.
8. Change the default password when prompted. Use a strong password which conforms to your company's password requirements.
9. Use these three commands to configure the network settings (text in *italics* indicates a variable):
`tcpip -i your IP address`
`tcpip -s your subnet mask`
`tcpip -g your default gateway`
10. Type `exit`, then press Enter. The Rack PDU restarts to apply the changes. The network connection is established when the Network Status LED turns solid green.

Web UI Access

After making a network connection with DHCP or manual settings, you can connect to the Web UI.

1. To access the Web UI, enter `https://your IP address` in your Web browser address field.
When connecting to the Web UI, you may receive a message that the Web page is not secure. This is normal, and you can continue to the Web UI on other browsers. (If your Web browser does not offer the option to continue to the Web UI, try a different browser.) The “Certificate Error Message” is generated because your Web browser does not recognize the default certificate used for encryption over HTTPS. However, information transmitted over HTTPS is still encrypted. See the ***Security Handbook, Network Management Card 3*** for more information.
2. You will be prompted for a user name and password. If you have not already set the password, enter **apc** (the default) for both the user name and password to log on. Then change the default password as directed. Use a strong password which conforms to your company's password requirements.

See the *NetShelter Advanced 11000 Series Rack Power Distribution Units User Guide* available on www.se.com for more configuration options.

Connecting Multiple Rack PDUs with Network Port Sharing

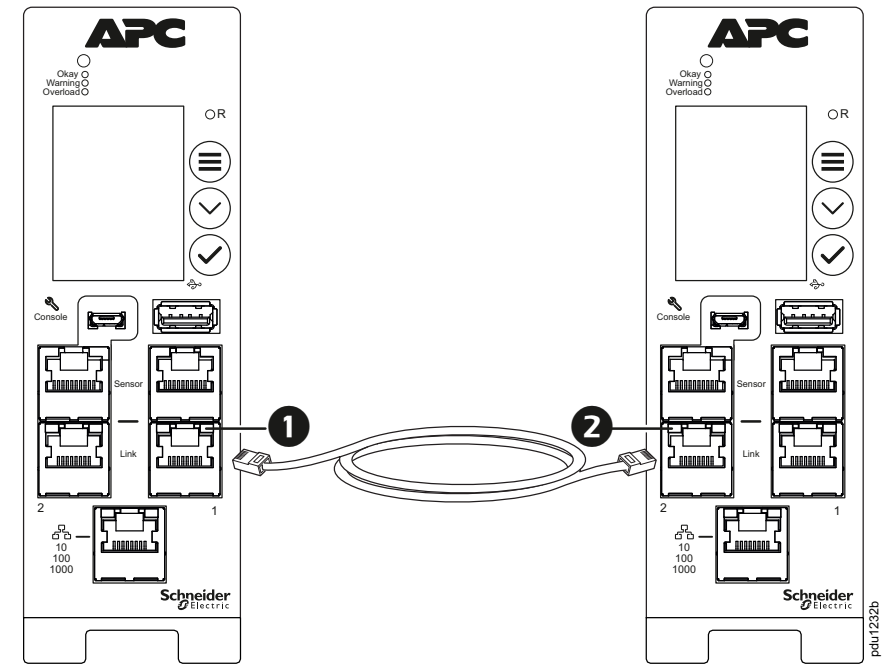

You can use Network Port Sharing (NPS) to connect up to 32 Rack PDUs with a single IP address.

To connect multiple Rack PDUs:

- Configure the network settings for the first Rack PDU. This is the Host of the NPS group.
- When the initial Rack PDU is configured, connect an Ethernet cable from the Link 1 port 1 on the configured Rack PDU to the Link 2 port 2 on the next Rack PDU. The second Rack PDU and all subsequent PDUs are Guests in the NPS group.
- Repeat the previous step to connect more Rack PDUs.

NOTE: To reduce the possibility of communication issues, the maximum total length of cabling (Cat5e+) connecting Rack PDUs in a group should not exceed 10 meters (32 ft).