

58.122

## ViewLite Monitor Arm 122

The 122 is equipped with two extensions allowing independent monitor depth adjustment, making the product suitable for dynamic setups. The step-less height adjustment provides each user with maximum ergonomic adjustment capabilities. Monitor cables can be easily hidden in both the pole and extensions of the arm.

- Step-less height adjustment over 370mm
- Step-less depth adjustment over 450mm
- Comes with both bolt through desk and desk clamp
- Suitable for desktop thicknesses of 5-40 (clamp) 50 (bolt through)mm
- Rotate 360°, tilt: +90°/-55°, swivel: 360°
- Easily mounted and adjusted
- VESA: MIS-D 75 x 75/100 x 100mm compatible
- Includes advanced and practical Quick Release VESA system
- Max. weight capacity 8kg/monitor (up to 24"/24"W)
- Main components produced from aluminium
- Integrated cable management
- Adjustable monitor rotation lock



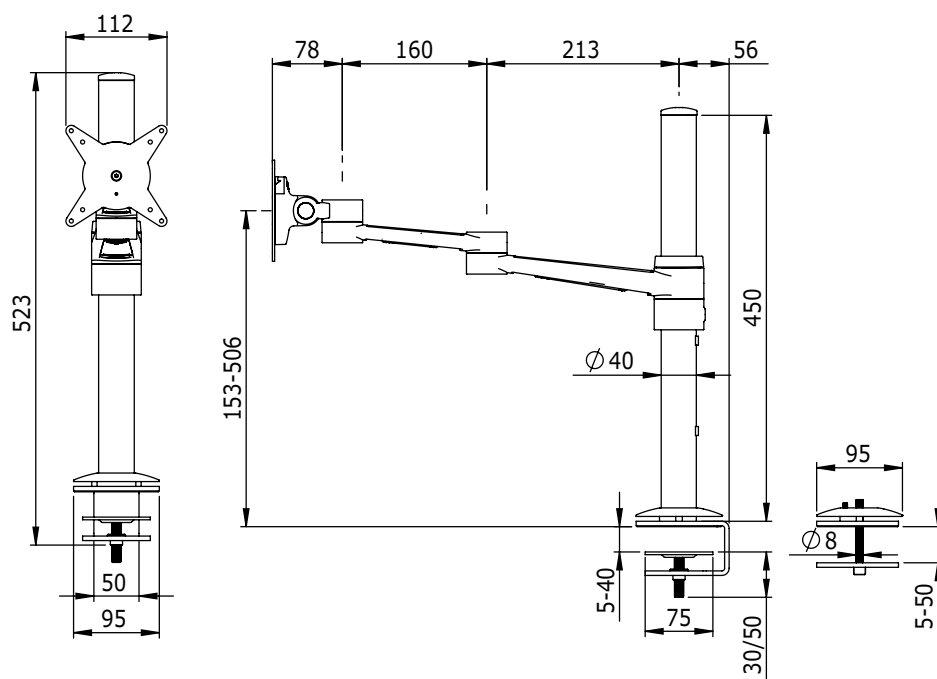
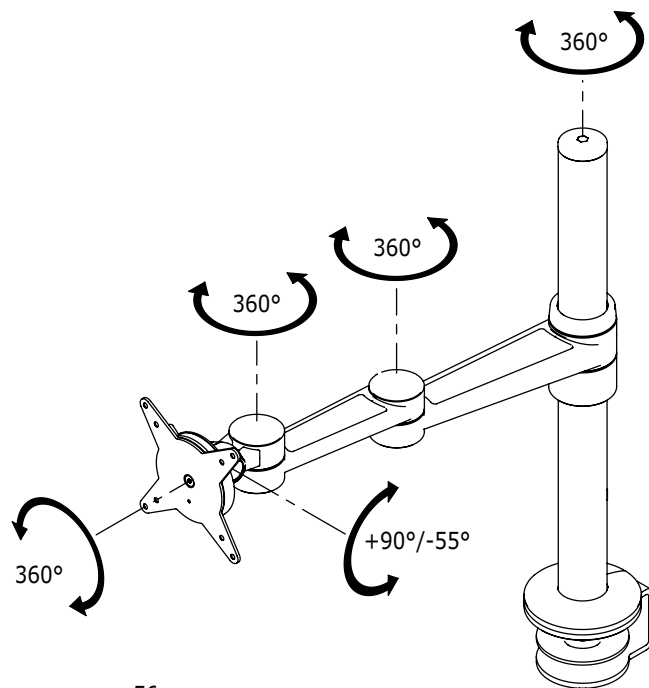

DFX.# 58.122



silver-white



648 x 178 x 169mm



4,105kg



805410581220



W: -mm (-")  
H: 978mm (38,5")



8kg



370mm



360°



+90°/-55°



360°



75/100mm

Dealer