

Easy PDU Temperature/Humidity Sensor

Installation

EPDU-TH

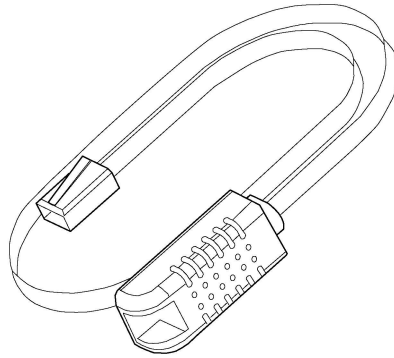

1. Peel the backing off one side of the double-sided mounting tape.
2. Apply the mounting tape to the back of the sensor.
3. Peel the backing off the other side of the mounting tape and press the sensor to the chosen location.

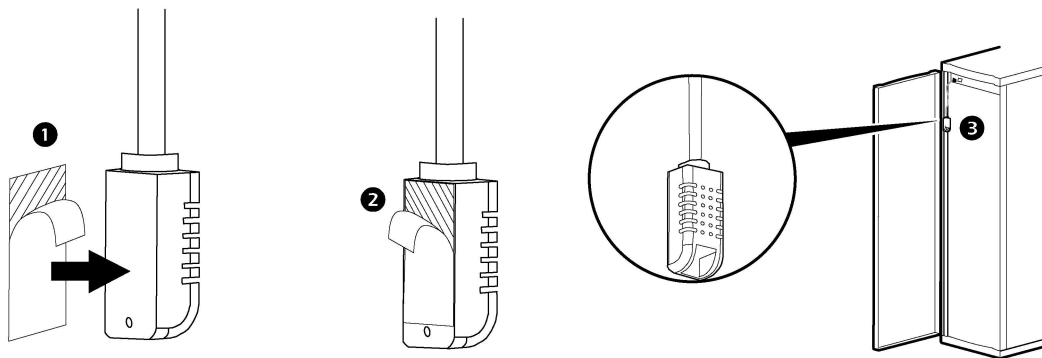

4. Route the cable to your monitoring appliance.
5. Use cable ties (not provided) to secure the cable
6. Connect the RJ45 connector on the end of the sensor's cable to the appropriate port of the monitoring appliance.

Specifications

Electrical	
Supply Voltage	3.3 - 5.5 VDC
Output	Digital (1 WIRE)
Physical	
Cable Length	2.0 m (6.5 ft)
Dimensions (L x W x H)	44.4 x 20.0 x 13.0 mm (17.5 x 0.8 x 0.5 in)
Shipping dimensions (L x W x H)	185 x 125 x 38 mm (7.28 x 4.92 x 1.50 in)
Weight	0.05 kg (0.11 lb)
Shipping weight	0.22kg (0.5 lb)
Environmental	
Temperature: Operating range	-40 to +80°C
Typical accuracy	±0.5°C
Temperature response time	5 seconds
Resolution	0.1°C
Relative Humidity: Operating Range	0~99.9% RH
Typical accuracy	±3% RH
Humidity response time	5 seconds
Resolution	0.1% RH
Compliance	
Safety verification	CE
Environmental	RoHS and Reach

Customer support and warranty information are available on the APC by Schneider Electric website, www.apc.com.

© 2020 APC by Schneider Electric. APC and the APC logo are owned by Schneider Electric S.E. All other trademarks are property of their respective owners.

990-6334
3/2020