

# DUAL-RTX3050-O6G

*2x Fans. 2x Fun.*

## ASUS Innovations

### NV Features

- **NVIDIA Ampere Streaming Multiprocessors:**  
The all-new Ampere SM brings 2X the FP32 throughput and improved power efficiency.
- **2nd Generation RT Cores:** Experience 2X the throughput of 1st gen RT Cores, plus concurrent RT and shading for a whole new level of ray-tracing performance.
- **3rd Generation Tensor Cores:** Get up to 2X the throughput with structural sparsity and advanced AI algorithms such as DLSS. These cores deliver a massive boost in game performance and all-new AI capabilities.



### Auto-Extreme Technology

Fully automated manufacturing for improved reliability and lower environmental impact.

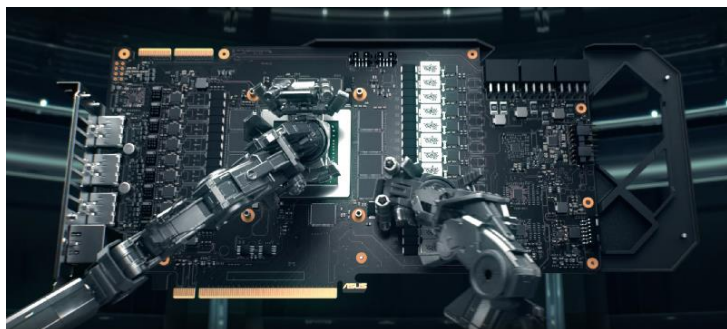

### Stainless Steel Bracket

The mounting bracket of the Dual has been beefed up with 304 Stainless Steel that's harder and more resistant to corrosion.



### IP5X Dust Resistance

IP5X Dust Resistance offers protection from the particle ingress for better durability.

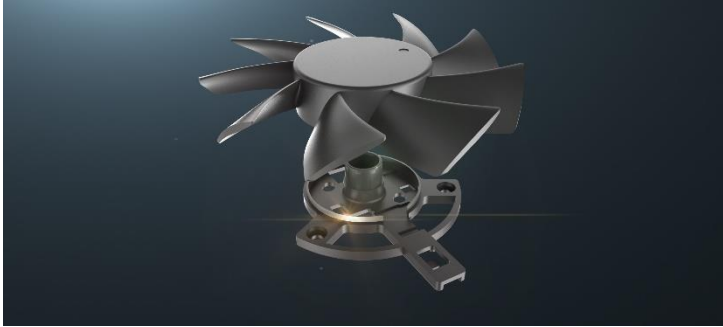

(Image is for reference only)

### GPU Tweak III

Hardware and software come together to let you fully customize your experience and get the most out of your graphics card. GPU Tweak III allows for hardware tweaking and monitoring.

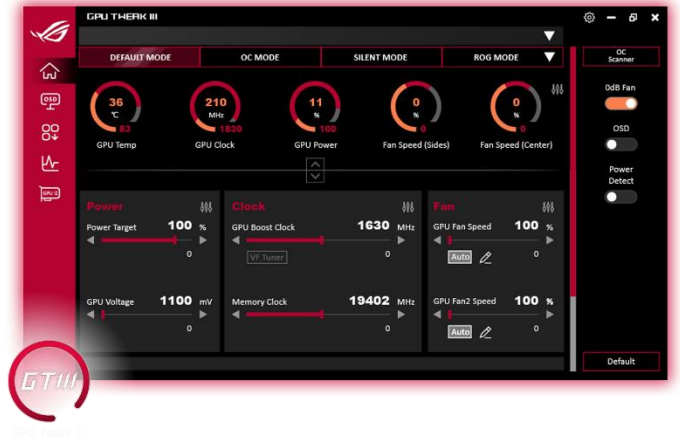

## ASUS Features

**OC**  
Edition

### OC edition

1537 MHz GPU boost clock in OC mode for outstanding gaming experience.

**6GB**  
GDDR6  
Memory

### 6GB GDDR6 Memory

On-board memory for the best gaming experience & the best resolution.

## I/O Specifications

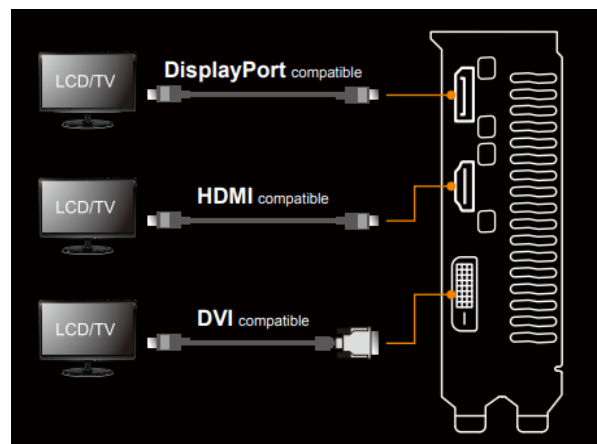

## NV Features



### GeForce Experience

Capture and share videos, screenshots, and livestreams with friends. Keep your drivers up to date and optimize your game settings. GeForce Experience lets you do it all. It's the essential companion to your GeForce graphics card.



### DirectX 12 Ultimate

Developers can now add even more amazing graphics effects to Microsoft Windows-based PC games. GeForce RTX graphics cards deliver advanced DX12 features like ray tracing and variable rate shading, bringing games to life with ultra-realistic visual effects and faster frame rates.



### RTX Video Super Resolution

RTX Video Super Resolution automatically enhances videos played in your Chrome or Edge browser using state-of-the-art AI algorithms to sharpen images and remove blocky and distracting compression artifacts. Enjoy crystal-clear video with up to 4K resolution.



### ShadowPlay

Now you can record and share gameplay videos and livestreams on YouTube, Twitch, and Facebook. NVIDIA ShadowPlay™ technology lets you broadcast with minimal performance overhead, so you never miss a beat in your games.



### NVIDIA G-SYNC

Get smooth, tear-free gameplay at high refresh rates, plus HDR and more. These are the ultimate gaming displays and the go-to equipment for enthusiast gamers.

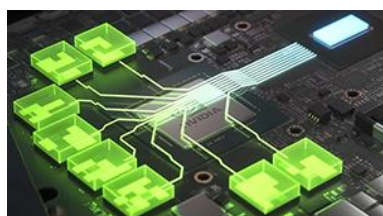

### Resizable BAR

Resizable BAR is an advanced PCI Express feature that enables the CPU to access the entire GPU frame buffer at once, improving performance in many games.

## Specifications

Model name	DUAL-RTX3050-O6G
Graphics Engine	NVIDIA® GeForce RTX™ 3050
CUDA cores	2304
OpenGL®	OpenGL® 4.6
Engine Clock	OC Mode : 1537 MHz (Boost Clock) Default Mode : 1507 MHz (Boost Clock)
Memory Interface	96-bit
Video Memory	6GB GDDR6
Memory Speed	14 Gbps
Power Connector	NA
I/O	1x Native HDMI 2.1 1x Native DisplayPort 1.4a 1x Native DVI-D
HDCP Compliant	HDCP 2.3
Digital Max. Resolution	7680 x 4320
Maximum Display Support	3
NVLink/Crossfire Support	N/A
Recommended PSU	450W
Bus Standard	PCIe 4.0
Package Contents	1 x Speedsetup Manual
Software Bundled	ASUS GPU Tweak III & GeForce Game Ready Driver & Studio Driver (Please download all software from the support site.)
Slot	2 slot
Dimension	
Card Size (mm/inch)	201 x 120 x 37mm 7.91 x 4.72 x 1.46 inches
Color Box (mm)	300 x 218 x 55
Weight	
Single Card (KG)	0.4
Product Weight (with packing) (KG)	0.702
<b>Note</b>	<p>* Our wattage recommendation is based on a fully overclocked GPU and CPU system configuration. For a more tailored suggestion, please use the "Choose By Wattage" feature on our PSU product page: <a href="https://rog.asus.com/event/PSU/ASUS-Power-Supply-Units/index.html">https://rog.asus.com/event/PSU/ASUS-Power-Supply-Units/index.html</a></p> <p>* All specifications are subject to change without notice. Please check with your supplier for exact offers.</p> <p>Products may not be available in all markets. If you do not use the latest and current specifications of ASUS products, you shall be liable for all loss and damage claimed by third party to ASUS based on false advertising or any other issues caused from using false specifications of ASUS products."</p>

