

58.512

ViewLite Plus Monitor Arm 512

The 512 offers the ability to mount a monitor on a rail system (3rd level) saving even more space on a desk. Swivel limiters can prevent the Plus from colliding into (partition) walls or other desks and can therefore be deployed almost everywhere.

- Dynamic height adjustment with a 240mm range
- Stepless depth adjustment with a 330mm range
- Rotate 360°, tilt: +90°/-30°, swivel: 360°
- Easily mounted and adjusted
- VESA: MIS-D 75 x 75/100 x 100mm compatible
- Includes advanced and practical Quick Release VESA system
- Max. weight capacity 7kg/monitor (up to 24"/24"W)
- Main components produced from aluminium
- Integrated cable management
- Clamp capacity rail 10-60mm
- Clamping bracket depth 9mm
- Adjustable monitor rotation lock
- Swivel limit possible (pre-set to +90°/-90°)



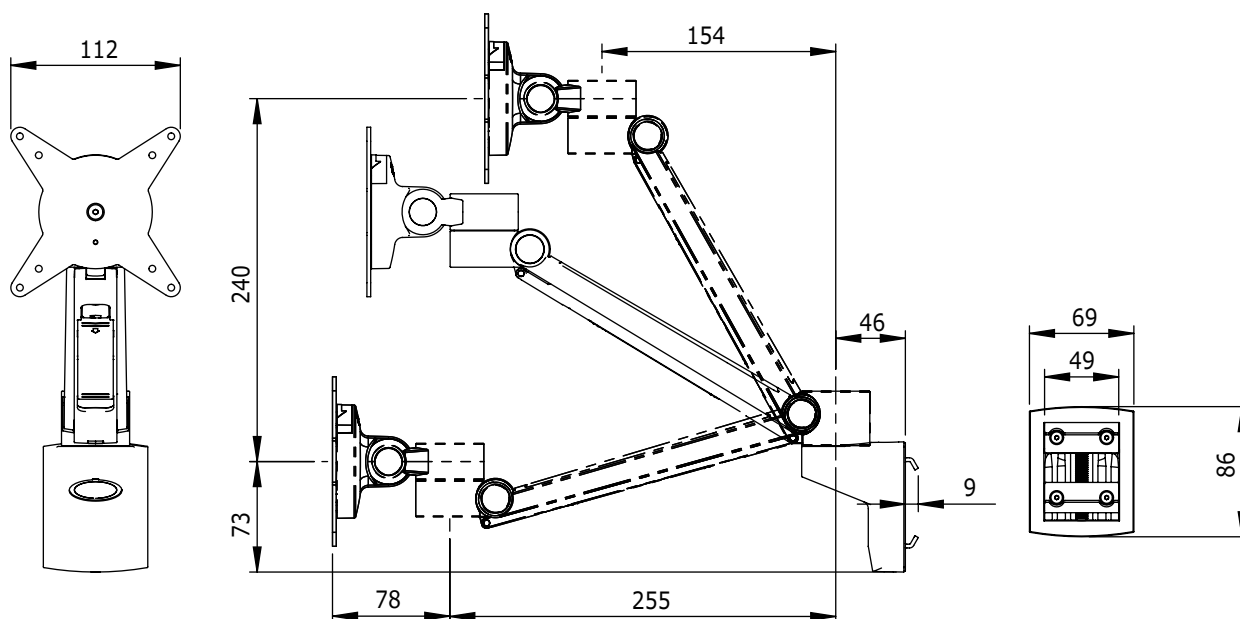
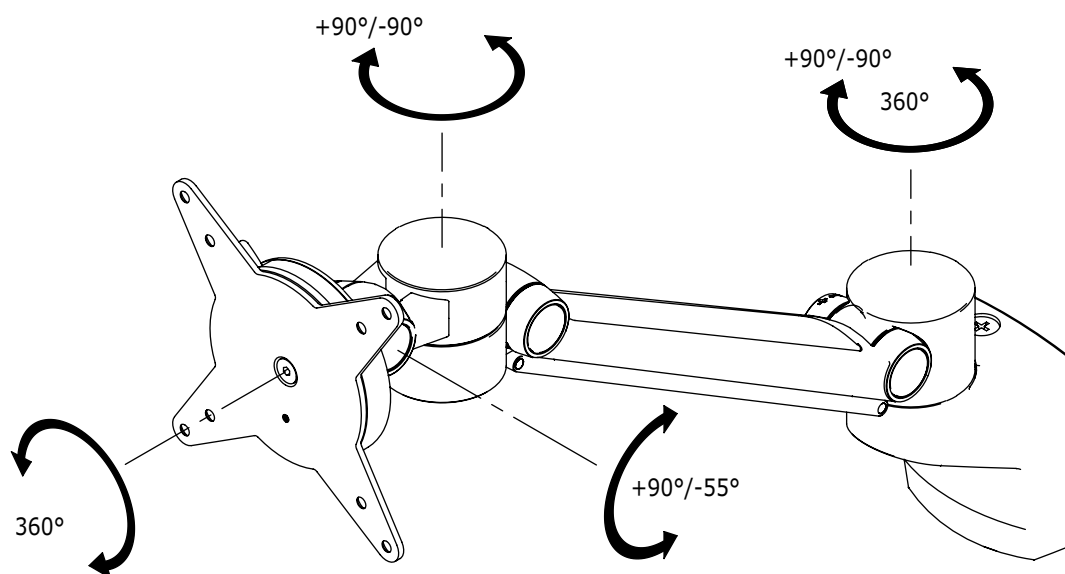

DFX.# 58.512



silver-white



477 x 153 x 145mm



1,7kg



805410585129



24"W/61cm



7kg



240mm



+90°/-90°



+90°/-55°



360°



75/100mm

Dealer