

# Delock M.2 Docking Station for M.2 NVMe PCIe SSD with USB Type-C™ female

## Description

This M.2 docking station by Delock enables the installation of an **M.2 PCIe NVMe SSD** and it can be connected via USB to the PC or laptop. The included USB cables allow the connection to a free USB Type-A or USB-C™ port.

### Ideal test equipment

The memory is **simply plugged** into the **robust metal housing** and can be used immediately. No screws, tools or accessories are required, which means that the SSD can be changed quickly.

**M.2 NVMe 10 Gbps**



## Specification

- Connectors:
  - 1 x SuperSpeed USB 10 Gbps (USB 3.2 Gen 2) USB Type-C™ female
  - 1 x 67 pin M.2 key M slot
- Chipset: Asmedia ASM2362
- Supports M.2 modules with key M or key B+M based on PCIe (NVMe)
- Supports NVM Express (NVMe)
- Bootable
- Data transfer rate up to 10 Gbps
- LED indicator for power and access
- 1 x On / Off switch
- Metal housing
- Dimensions (LxWxH): ca. 49 x 49 x 12 mm
- Hot Plug, Plug & Play

## System requirements

- Chrome OS 78.0 or above
- Linux Kernel 4.3 or above
- Mac OS 10.15.2 or above
- Windows 8.1/8.1-64/10/10-64
- PC or laptop with a free USB Type-C™ port or
- PC or laptop with a free USB Type-A port

## Package content

- M.2 docking station
- Cable USB-C™ male to USB-C™ male, length ca. 30 cm
- Cable USB-C™ male to USB Type-A male, length ca. 30 cm
- User manual

Item no. 64000

EAN: 4043619640003

Country of origin: China

Package: • Retail Box



## Images

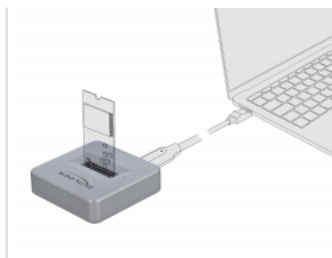

| General                     |   |
|-----------------------------|---|
| Function:                   | Plug & Play<br>bootable   |
| Supported operating system: | Windows 8.1 32-bit<br>Windows 8.1 64-bit<br>Windows 10 32-bit<br>Windows 10 64-bit<br>Linux Kernel 4.3 or above<br>Chrome OS 78.0 or above<br>Mac OS 10.15.2 or above |
| LED indicator:              | 1 x   |
| Interface                   |   |
| Connector 1:                | 1 x SuperSpeed USB 10 Gbps (USB 3.2 Gen 2) USB Type-C™ female   |
| Connector 2:                | 1 x 67 pin M.2 key M slot   |
| Technical characteristics   |   |
| Chipset:                    | Asmedia ASM2362   |
| Data transfer rate:         | 10 Gbps   |
| Physical characteristics    |   |
| Length:                     | 49 mm   |
| Width:                      | 49 mm   |
| Height:                     | 12 mm   |
| Colour:                     | silver  |