

ergotron®

moving you forward

HX **Desk Monitor Arm**

- Allows you to work comfortably and helps reduce eye, back and neck strain
- Adjust displays with a light touch, thanks to Constant Force™ technology
- Frees up space in tight areas by folding arm when not in use
- Passes Ergotron's 10,000-cycle motion test for years of trouble-free height adjustment
- 10-year warranty
- Multiple desk attachment options included with HX arms and as accessory kits

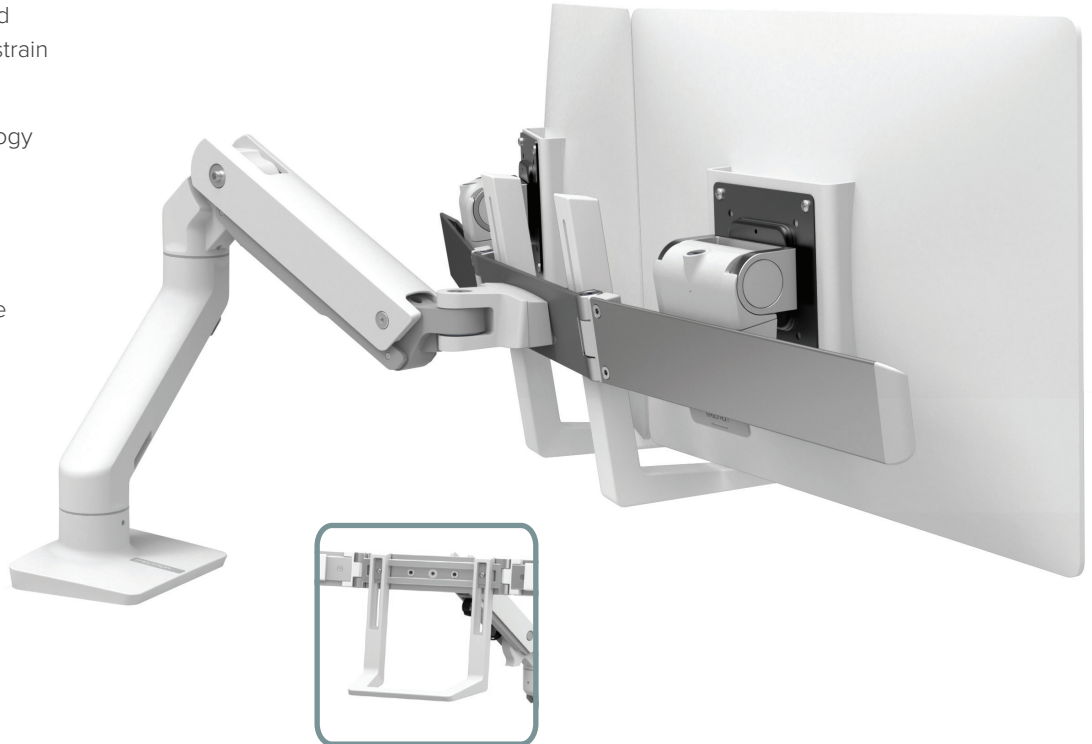

SLEEK NEW POST DESIGN



The HX Monitor Arm is the perfect accessory to add flexibility and superior ergonomics to your monitor(s). The dual/triple hinge bow works with two 32" or three 24" monitors and includes a handle for easy positioning.

HX Desk Monitor Arm

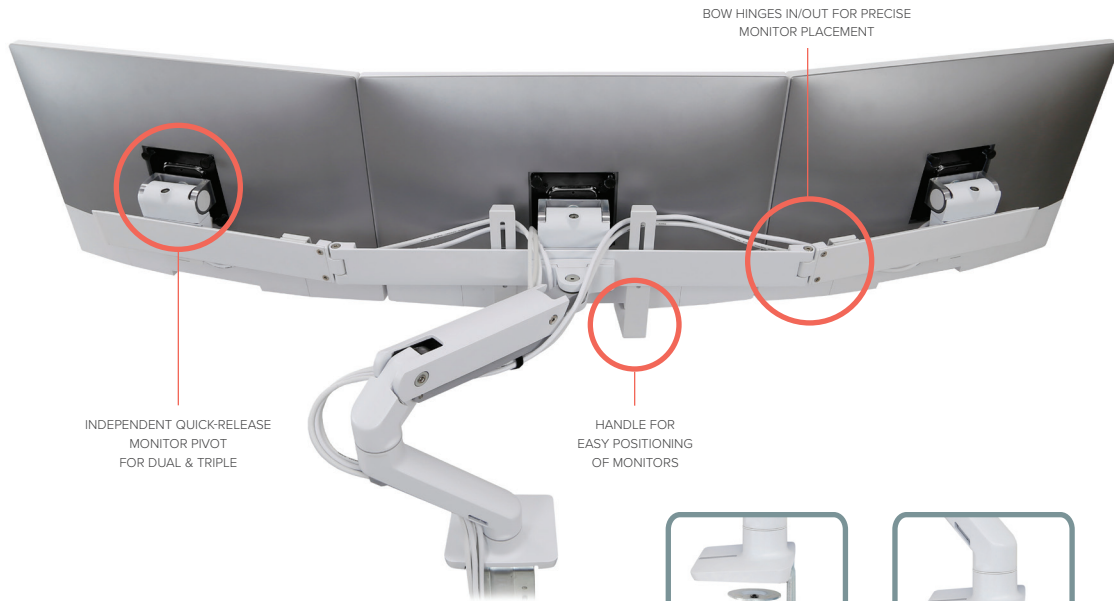

WHITE HX DESK MONITOR ARM
WITH HX TRIPLE MONITOR BOW KIT



Large, ultra-wide or curved monitors continue to grow in popularity with gamers and office users. Our popular HX Desk and Wall Monitor Arms needed a new tilt pivot to support monitors 15,2–30,4 cm deep.
HX HEAVY-DUTY TILT PIVOT 98-540-216



INCLUDED:
STANDARD 2-PIECE DESK CLAMP
ATTACHES TO SURFACE EDGE



INCLUDED:
GROMMET MOUNT ATTACHES
THROUGH SURFACE HOLES



CABLES ROUTE BENEATH
THE ARM, OUT OF THE WAY

	HX Desk Monitor Arm	HX Desk Dual Monitor Arm	HX Triple Monitor Bow Kit
Part # color	45-475-216 white 45-475-224 matte black	45-476-216 white 45-476-224 matte black	98-009-216 white
Includes	HX Arm, extension, monitor pivot, desk clamp, grommet mount, monitor mounting hardware	HX Arm, extension, hinge bow, 2 monitor pivots, handle, desk clamp, grommet mount, monitor mounting hardware	Triple Monitor Hinge Bow, 3 monitor pivots, handle and monitor mounting hardware
Typical LCD Size	≤ 42"	≤ 32"	≤ 24"
<small>LCD SIZE IS APPROXIMATION. DIMENSION IS DIAGONAL MEASUREMENT OF SCREEN. LCD SIZE ON HX SINGLE MAY BE EXCEEDED AS LONG AS SCREEN WEIGHT DOES NOT EXCEED MAXIMUM WEIGHT CAPACITY OF THE MOUNT.</small>			
Weight Capacity	9–19 kg per monitor; use HX tilt accessory 98-540-216 for monitor depth > 15 cm and weight > 12,7 kg	2,3–8 kg per monitor	1–4,6 kg per monitor
Lift	29,2 cm		
Tilt	↑ 70° / ↓ 5° Quick release monitor on Dual and Triple only		
Extension Pan	360°		
Base Rotation	180°		
VESA	VESA FDMI MIS-D, 100/75, C (100 x 100 mm & 75 x 75 mm hole pattern); HX Single also includes 200 x 200 mm		
Extension	≤ 60 cm	≤ 62 cm	≤ 62,2 cm
Shipping Weight	8,3 kg	12,2 kg	8,7 kg
Shipping Dimensions	30,5 x 48,8 x 17,8 cm	41 x 48 x 19 cm	47 x 72 x 19 cm
Warranty	10 years		
Pro Install Option	SRVC-PI-01	SRVC-PI-02	SRVC-PI-02

Download additional literature at ergotron.com
For more information:
EMEA +31.33.45.45.600 / info.eu@ergotron.com
Custom: custom@ergotron.com

© Ergotron, Inc. 08.12.2020

Content subject to change.

Patent information available at www.ergotron.com/patents.

Ergotron devices are not intended to cure, treat, mitigate or prevent any disease.

