



## Product Range

3Dconnexion creates the world's most advanced, precise and comfortable peripherals. Optimized for over 300 software packages, our products help engineers, architects and designers create better designs more efficiently.

## SpaceMouse® Enterprise

BUILT FOR TOP ENGINEERING PERFORMANCE

At the top, there is no room for second best. The world's premier firms demand the highest level of performance from their engineering teams. There are no excuses for missed opportunities; there are only results.



**Professional 3D Navigation in CAD** – Intuitively and precisely navigate digital models or views with the patented Six-Degrees-of-Freedom (6DoF) sensor.

**QuickView Keys** – One touch access to 32 Standard Views plus three Custom Views (exclusive to SpaceMouse Enterprise).

**8 Keyboard Modifiers** – The most comprehensive array of keyboard modifiers including Enter, Delete, Ctrl, Shift, Alt, Esc, Space and Tab.

**12 Intelligent Function Keys** – Quickly execute your favourite commands (automatically updates as you change application and environment.)

**Colour LCD** – Supports the Intelligent Function Keys by displaying the actual icons from your application toolbar.

**On-Screen Display** – Provides a visual reminder of function key assignments on your computer screen.

**Ergonomic design** – Full size hand rest and large, keyboard like buttons.

**Extended Support** – Three years warranty + additional one year (requires product registration) and automatic priority technical support.

# SpaceMouse® Product Line

## SpaceMouse® Pro

THE STANDARD FOR ENGINEERING

SpaceMouse Pro delivers advanced comfort and easy access to professional features for a simple, productive workflow.



**Professional 3D Navigation in CAD** – Intuitively and precisely navigate digital models or views with the patented Six-Degrees-of-Freedom (6DoF) sensor.

**QuickView Keys** – One touch access to 12 views.

**4 Keyboard Modifiers** – Conveniently positioned Ctrl, Shift, Alt and Esc keys.

**4 Intelligent Function Keys** – Quickly execute your favourite commands (automatically updates as you change application and environment).

**On-Screen Display** – Provides a visual reminder of function key assignments on your computer screen.

**Ergonomic design** – Full size hand rest and large, keyboard like buttons.

Wireless version also available:  
SpaceMouse® Pro Wireless



# SpaceMouse® Product Line

## SpaceMouse® Wireless

ADVANCED 3D NAVIGATION ANYWHERE

Whether you are reviewing 3D drawings in a meeting room or presenting 3D design ideas at your partner office, SpaceMouse Wireless offers you the functionality to navigate efficiently in CAD applications anywhere.

**Professional 3D Navigation in CAD** – Intuitively and precisely navigate digital models or views with the patented Six-Degrees-of-Freedom (6DoF) sensor.

**Wireless Freedom** – 3Dconnexion® 2.4GHz Wireless technology ensures a reliable, real-time connection to your 3D content.

**One Month of Battery Life** – SpaceMouse Wireless will operate for up to a month between charges.

**Pure, functional design** – Small footprint, elegant brushed steel base, two conveniently positioned buttons.



**Tailor made carry case included** – Durable, hard sided case for protection.



## SpaceMouse® Compact

DESIGNED FOR ADVANCED 3D NAVIGATION

With its iconic, pure design the SpaceMouse Compact was developed for users who search for an intuitive, precise and effortless navigation within the 3D environment of their CAD applications.

**Professional 3D Navigation in CAD** – Intuitively and precisely navigate digital models or views with the patented Six-Degrees-of-Freedom (6DoF) sensor.

**Pure, functional design** – Small footprint, elegant brushed steel base, two conveniently positioned buttons.



# SpaceMouse® Comparison



SpaceMouse Enterprise

SpaceMouse Pro Wireless

SpaceMouse Pro

SpaceMouse Wireless

SpaceMouse Compact

Navigation	Ultimate 3D Navigation	Professional 3D Navigation	Professional 3D Navigation	Advanced 3D Navigation	Advanced 3D Navigation
Design	Superior Ergonomics	Advanced Ergonomics	Advanced Ergonomics	Compact Ergonomics	Compact Ergonomics
Application Command Keys	12	4	4	-	-
Programmable Keys	31	15	15	2	2
Display	LCD Display On-Screen-Display	On-Screen-Display	On-Screen-Display	-	-
QuickView Keys	10, with Rotation Lock (Including Status LED)	4, with Rotation Lock	4, with Rotation Lock	-	-
Keyboard Modifier	8	4	4	-	-
CustomView Keys	3	-	-	-	-
Connectivity	USB cable	2,4GHz wireless technology or USB cable	USB cable	2,4GHz wireless technology or USB cable	USB cable
Battery life*	-	2 months	-	1 month	-
Warranty	3+1** years	3 years	3 years	2 years	2 years
Bespoke Carry Case	-	✓	-	✓	-
Size (LxWxH)	249 x 154 x 58 mm 9.8 x 6.1 x 2.3 in	204 x 142 x 58 mm 8 x 5.6 x 2.3 in	204 x 142 x 58 mm 8 x 5.6 x 2.3 in	78 x 78 x 53 mm 3.07 x 3.07 x 2.09 in	77 x 77 x 54 mm 3.03 x 3.03 x 2.13 in
Weight	800 g / 28,22 oz / 1.76 lbs	563 g / 19.86 oz / 1.24 lbs	670 g / 23.63 oz / 1.48 lbs	450 g / 15.87 oz / 0.99 lbs	480 g / 16.93 oz / 1.06 lbs

\* Battery life based on 8 hours per day, 5 days per week use

\*\* Additional one-year warranty requires product registration within 90 days of purchase date.

# CadMouse Product Line

## CadMouse Pro Wireless

### THE PRECISION ERGONOMIC MOUSE FOR CAD PROFESSIONALS

A full-size mouse designed specifically for the modern CAD professional. Offering superior ergonomics, a dedicated middle mouse button, high resolution optical sensor and up to three-months use between charges.



Left-side solution also available:  
CadMouse Pro Wireless Left



CadMouse Pro Wireless Left, CadMouse Pad

**Dedicated Middle Mouse Button** – the days of clicking the mouse wheel are over thanks to the CadMouse's intelligent ergonomic design.

**Triple Connectivity** – Connect with 3Dconnexion Universal Receiver, Bluetooth, or USB cable.

**Rechargeable Lithium Polymer Battery** – 3 months battery life and recharging via USB cable while working.

**QuickZoom** – Effortlessly zoom in and out of your geometry with a single click of a thumb button. Fine-tune the zoom level by keeping the button pressed.

**SmartScroll** – Automatic click-to-click zooming in CAD applications and speedy scrolling in documents and browsers.

**Top Button** – Easy access up to 8 of your favorite commands (automatically updates as you change application and environment).

**Optimized tactile feedback** – optimally shaped PTFE feet provide a constant reaction force and vibration damping for a smooth mouse movement.



**Bespoke carry case included** –  
Durable, hard sided case for protection.

# CadMouse Product Line

## CadMouse Pro

### PURPOSE-BUILT FOR PROFESSIONALS

The industry-acclaimed purpose-built mouse specifically suited for design and engineering professionals. Featuring advanced ergonomics and precise calibration, the full-size wired mouse offers exceptional comfort and maximal durability.



**Dedicated Middle Mouse Button** – the days of clicking the mouse wheel are over thanks to the CadMouse's intelligent ergonomic design.

**QuickZoom** – Effortlessly zoom in and out of your geometry with a single click of a thumb button. Fine-tune the zoom level by keeping the button pressed.

**SmartScroll** – Automatic click-to-click zooming in CAD applications and speedy scrolling in documents and browsers.

**Top Button** – Easy access up to 8 of your favorite commands (automatically updates as you change application and environment).

**Optimized tactile feedback** – optimally shaped PTFE feet provide a constant reaction force and vibration damping for a smooth mouse movement.

See website or contact us for details of supported applications.



CadMouse Pro, CadMouse Pad

## CadMouse Compact Wireless

DESIGNED FOR THE MOBILE CAD SPECIALIST

The compact wireless mouse with a high precision, energy saving optical sensor and a battery life up to 3 months.



CadMouse Compact Wireless, CadMouse Pad Compact

**Dedicated Middle Mouse Button** – the days of clicking the mouse wheel are over thanks to the CadMouse's intelligent ergonomic design.

**Triple Connectivity** – Connect with 3Dconnexion Universal Receiver, Bluetooth, or USB cable.

**Rechargeable Li-Ion Battery** – 3 months battery life and recharging via USB cable while working.

**QuickZoom** – Effortlessly zoom in and out of your geometry with a single click of a thumb button. Fine-tune the zoom level by keeping the button pressed.

**SmartScroll** – Automatic click-to-click zooming in CAD applications and speedy scrolling in documents and browsers.

**Top Button** – Easy access up to 8 of your favorite commands (automatically updates as you change application and environment).

**Optimized tactile feedback** – optimally shaped PTFE feet provide a constant reaction force and vibration damping for a smooth mouse movement.



**Bespoke carry case included** – Durable, hard sided case for protection.



# CadMouse Product Line

## CadMouse Compact

### COMPACT ERGONOMIC MOUSE FOR PROFESSIONALS

The ultimate wired mouse specifically suited for design and engineering professionals who prefer to use a compact form factor for their hand size and grip type.



**Dedicated Middle Mouse Button** – the days of clicking the mouse wheel are over thanks to the CadMouse's intelligent ergonomic design.

**QuickZoom** – Effortlessly zoom in and out of your geometry with a single click of a thumb button. Fine-tune the zoom level by keeping the button pressed.

**SmartScroll** – Automatic click-to-click zooming in CAD applications and speedy scrolling in documents and browsers.

**Top Button** – Easy access up to 8 of your favorite commands (automatically updates as you change application and environment).

**Optimized tactile feedback** – optimally shaped PTFE feet provide a constant reaction force and vibration damping for a smooth mouse movement.

See website or contact us for details of supported applications.

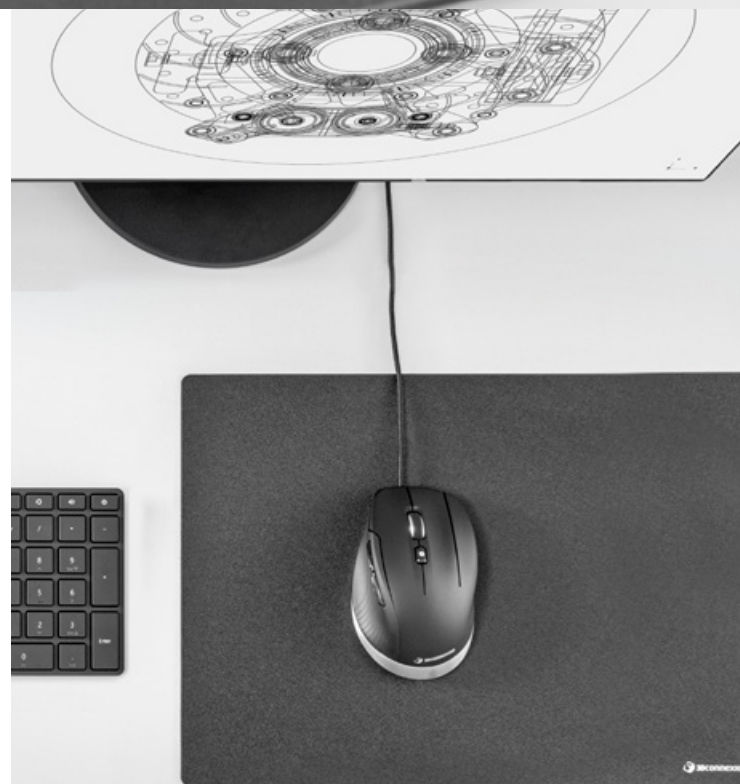

CadMouse Compact, CadMouse Pad

# CadMouse Comparison



CadMouse Pro  
Wireless



CadMouse Pro  
Wireless Left



CadMouse Pro



CadMouse Compact  
Wireless



CadMouse Compact

Design	Full-size ergonomic	Full-size ergonomic	Full-size ergonomic	Compact ergonomic	Compact ergonomic
Dedicated middle mouse button	✓	✓	✓	✓	✓
5 programmable buttons	✓	✓	✓	✓	✓
High resolution optical sensor	7200 DPI	7200 DPI	7200 DPI	7200 DPI	7200 DPI
Switches' mechanical life	50 million clicks	50 million clicks	50 million clicks	50 million clicks	50 million clicks
Connectivity	Universal Receiver, Bluetooth or USB cable	Universal Receiver, Bluetooth or USB cable	USB cable	Universal Receiver, Bluetooth or USB cable	USB cable
Battery life*	Up to 3 months	Up to 3 months	-	Up to 3 months	-
Warranty	3 years	3 years	3 years	2 years	2 years
Bespoke Carry Case	✓	✓	-	✓	-
Size (LxWxH)	126 x 74 x 44 mm 5.0 x 2.9 x 1.7 in	126 x 74 x 44 mm 5.0 x 2.9 x 1.7 in	126 x 74 x 44 mm 5.0 x 2.9 x 1.7 in	110 x 67 x 38 mm 4.3 x 2.7 x 1.5 in	115 x 71 x 41 mm 4.5 x 2.8 x 1.6 in
Weight	140 g / 4.94 oz / 0.31 lbs	140 g / 4.94 oz / 0.31 lbs	110 g / 3.88 oz / 0.24 lbs	110 g / 3.88 oz / 0.24 lbs	96 g / 3.39 oz / 0.21 lbs

\*Battery life based on 8 hours per day, 5 days per week use.



## CadMouse Pad

PERFECT BALANCE BETWEEN PRECISION AND COMFORT

The optional CadMouse Pad supports an even smoother and more precise movement thanks to its high-quality micro-textured coating.

Available in 2 sizes – CadMouse Pad (350 x 250 mm)  
and CadMouse Pad Compact (250 x 250 mm)

# Keyboard

## Keyboard Pro with Numpad

DESIGNED FOR CAD PROFESSIONALS, CREATIVES AND MAKERS

The full-sized keyboard with detached numpad is engineered to help you create digital 3D models and professional designs.



**Better posture. Better workflow.** – Its compact width enables a better position of your mouse or pen resulting in a more natural and comfortable posture. You can use your mouse and the numpad simultaneously – making your workflow faster and easier.

**3Dconnexion keys that adapt to your apps** – Twelve dedicated and programmable function keys give you instant access to the app-specific commands you use most.

**Programmable wireless numpad** – Integrates seamlessly into workflows, with nine programmable keys, including four 3Dconnexion keys, and secure encrypted connectivity.

**Precise and effortless typing** – The keycaps are ergonomically shaped and matte-coated for comfort and precision. Scissor technology gives stability, low friction and perfect responsiveness.

**Advanced wrist support** – A full-sized palm rest provides support for reduced wrist fatigue. The keyboard is exceptionally slim, with foldout feet for adjustment.

**Secure connectivity** – The wired keyboard and encrypted connection to the numpad ensure security. An embedded hub connects all 3Dconnexion wireless devices.

## SpaceMouse® Enterprise Kit 2

### THE ULTIMATE CAD SOLUTION

The most natural and ergonomic workstyle for CAD professionals, offering engineering professionals the best for an ergonomic and efficient two-handed workflow.

**Included products:**

- SpaceMouse Enterprise
- CadMouse Pro Wireless with case
- CadMouse Pad
- 3Dconnexion Universal Receiver
- Twin-port USB hub
- Micro-USB Cable 1.5m
- Micro-USB Cable 0.5m

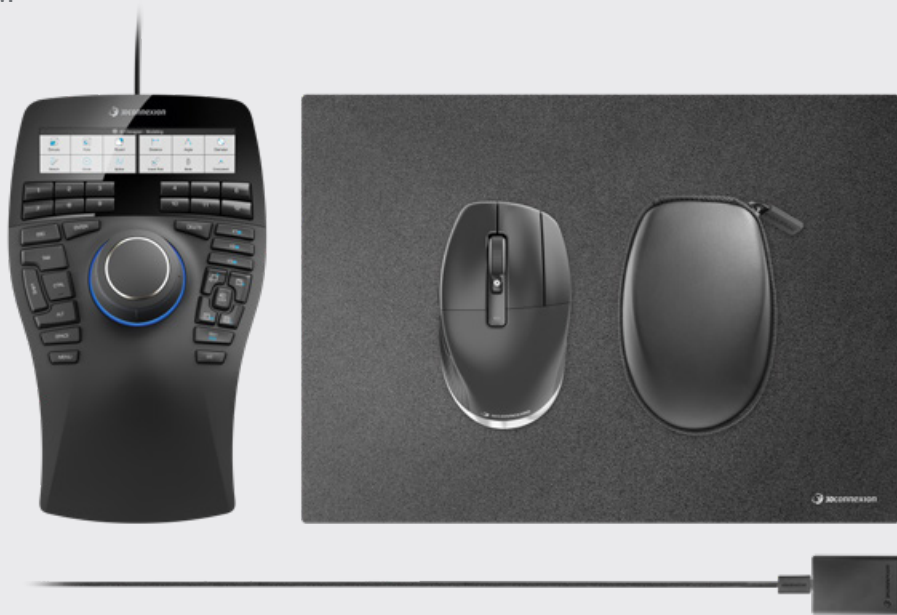

## SpaceMouse® Wireless Kit 2

### THE MOBILE CAD SOLUTION

The wireless engineering solution which meets the demands of mobile workers for a durable, flexible working equipment.

**Included products:**

- SpaceMouse Wireless with case
- CadMouse Compact Wireless with case
- CadMouse Pad Compact
- 3Dconnexion Universal Receiver
- Micro-USB Cable



For more information visit  
[3dconnexion.com](https://3dconnexion.com)